

All dimensions are imperial unless stated.

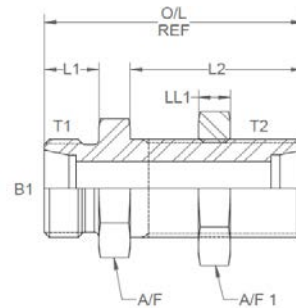

	T1	T2	B1	L1	L2	O/L	A/F	A/F1
01-06S-BH	M14 x 1.5	M14 x 1.5	0.157	0.472	1.417	2.162	19mm	19mm
01-08S-BH	M16 x 1.5	M16 x 1.5	0.197	0.472	1.417	2.204	22mm	22mm
01-10S-BH	M18 x 1.5	M18 x 1.5	0.276	0.472	1.457	2.323	24mm	24mm
01-12S-BH	M20 x 1.5	M20 x 1.5	0.315	0.472	1.496	2.362	27mm	27mm
01-14S-BH	M22 x 1.5	M22 x 1.5	0.394	0.551	1.574	2.559	30mm	30mm
01-16S-BH	M24 x 1.5	M24 x 1.5	0.472	0.551	1.574	2.559	32mm	32mm
01-20S-BH	M30 x 2	M30 x 2	0.630	0.630	1.732	2.835	41mm	41mm
01-25S-BH	M36 x 2	M36 x 2	0.787	0.709	1.850	3.110	46mm	46mm
01-30S-BH	M42 x 2	M42 x 2	0.984	0.787	2.001	3.386	50mm	50mm
01-38S-BH	M52 x 2	M52 x 2	1.260	0.866	2.086	3.582	65mm	65mm

Add -CWNR to part number for complete with nuts and rings, i.e. 01-06S-BH-CWNR.

DESIGN DETAILS AND SPECIFICATIONS SUBJECT TO CHANGE WITHOUT PRIOR NOTICE - Whilst every effort has been made to ensure the accuracy of the information supplied herein, Burnett & Hillman cannot be held responsible for any errors or omissions (E&OE)

A/F dimensions are imperial unless stated.

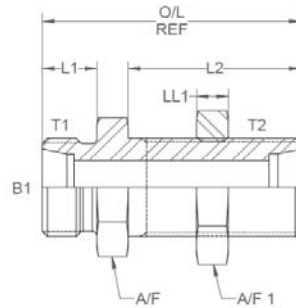

	T1	T2	B1	L1	L2	O/L	A/F	A/F1
01-06S-BH	M14 x 1.5	M14 x 1.5	3.99	11.99	35.99	54.91	19mm	19mm
01-08S-BH	M16 x 1.5	M16 x 1.5	5.00	11.99	35.99	55.98	22mm	22mm
01-10S-BH	M18 x 1.5	M18 x 1.5	7.01	11.99	37.01	59.00	24mm	24mm
01-12S-BH	M20 x 1.5	M20 x 1.5	8.00	11.99	38.00	59.99	27mm	27mm
01-14S-BH	M22 x 1.5	M22 x 1.5	10.01	14.00	39.98	65.00	30mm	30mm
01-16S-BH	M24 x 1.5	M24 x 1.5	11.99	14.00	39.98	65.00	32mm	32mm
01-20S-BH	M30 x 2	M30 x 2	16.00	16.00	43.99	72.01	41mm	41mm
01-25S-BH	M36 x 2	M36 x 2	19.99	18.01	46.99	78.99	46mm	46mm
01-30S-BH	M42 x 2	M42 x 2	24.99	19.99	50.83	86.00	50mm	50mm
01-38S-BH	M52 x 2	M52 x 2	32.00	22.00	52.98	90.98	65mm	65mm

Add -CWNR to part number for complete with nuts and rings, i.e. 01-06S-BH-CWNR.

DESIGN DETAILS AND SPECIFICATIONS SUBJECT TO CHANGE WITHOUT PRIOR NOTICE - Whilst every effort has been made to ensure the accuracy of the information supplied herein, Burnett & Hillman cannot be held responsible for any errors or omissions (E&OE)