

All dimensions are imperial unless stated.

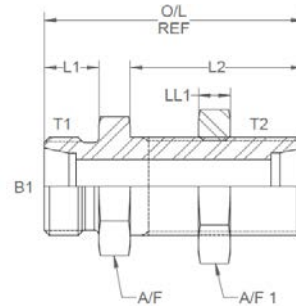

	T1	T2	B1	L1	L2	O/L	A/F	A/F1
01-06L-BH	M12 x 1.5	M12 x 1.5	0.157	0.394	1.339	1.890	17mm	17mm
01-08L-BH	M14 x 1.5	M14 x 1.5	0.236	0.394	1.339	1.929	19mm	19mm
01-10L-BH	M16 x 1.5	M16 x 1.5	0.312	0.433	1.377	2.047	22mm	22mm
01-12L-BH	M18 x 1.5	M18 x 1.5	0.394	0.433	1.417	2.086	24mm	24mm
01-15L-BH	M22 x 1.5	M22 x 1.5	0.472	0.472	1.496	2.244	27mm	30mm
01-18L-BH	M26 x 1.5	M26 x 1.5	0.591	0.472	1.574	2.401	32mm	36mm
01-22L-BH	M30 x 2	M30 x 2	0.748	0.551	1.653	2.598	36mm	41mm
01-28L-BH	M36 x 2	M36 x 2	0.945	0.551	1.693	2.716	41mm	46mm
01-35L-BH	M42 x 2	M45 x 2	1.181	0.630	1.850	2.992	50mm	55mm
01-42L-BH	M52 x 2	M52 x 2	1.417	0.630	1.850	3.031	60mm	65mm

**Add -CWNR to part number for complete with nuts and rings, i.e. 01-06L-BH-CWNR.**

DESIGN DETAILS AND SPECIFICATIONS SUBJECT TO CHANGE WITHOUT PRIOR NOTICE - Whilst every effort has been made to ensure the accuracy of the information supplied herein, Burnett & Hillman cannot be held responsible for any errors or omissions (E&OE)

A/F dimensions are imperial unless stated.

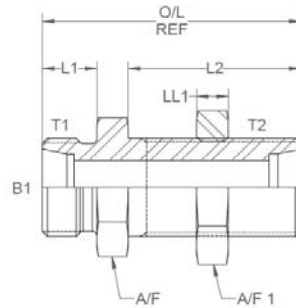

	T1	T2	B1	L1	L2	O/L	A/F	A/F1
01-06L-BH	M12 x 1.5	M12 x 1.5	3.99	10.01	34.01	48.01	17mm	17mm
01-08L-BH	M14 x 1.5	M14 x 1.5	5.99	10.01	34.01	49.00	19mm	19mm
01-10L-BH	M16 x 1.5	M16 x 1.5	7.92	11.00	34.98	51.99	22mm	22mm
01-12L-BH	M18 x 1.5	M18 x 1.5	10.01	11.00	35.99	52.98	24mm	24mm
01-15L-BH	M22 x 1.5	M22 x 1.5	11.99	11.99	38.00	57.00	27mm	30mm
01-18L-BH	M26 x 1.5	M26 x 1.5	15.01	11.99	39.98	60.99	32mm	36mm
01-22L-BH	M30 x 2	M30 x 2	19.00	14.00	41.99	65.99	36mm	41mm
01-28L-BH	M36 x 2	M36 x 2	24.00	14.00	43.00	68.99	41mm	46mm
01-35L-BH	M42 x 2	M45 x 2	30.00	16.00	46.99	76.00	50mm	55mm
01-42L-BH	M52 x 2	M52 x 2	35.99	16.00	46.99	76.99	60mm	65mm

**Add -CWNR to part number for complete with nuts and rings, i.e. 01-06L-BH-CWNR.**

DESIGN DETAILS AND SPECIFICATIONS SUBJECT TO CHANGE WITHOUT PRIOR NOTICE - Whilst every effort has been made to ensure the accuracy of the information supplied herein, Burnett & Hillman cannot be held responsible for any errors or omissions (E&OE)