

All dimensions are imperial unless stated.

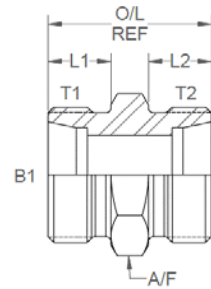

	T1	T2	B1	L1	L2	O/L	A/F
01-06S	M14 x 1.5	M14 x 1.5	0.157	0.472	0.472	1.181	14mm
01-08S	M16 x 1.5	M16 x 1.5	0.197	0.472	0.472	1.26	17mm
01-10S	M18 x 1.5	M18 x 1.5	0.276	0.472	0.472	1.26	19mm
01-12S	M20 x 1.5	M20 x 1.5	0.315	0.472	0.472	1.339	22mm
01-14S	M22 x 1.5	M22 x 1.5	0.394	0.551	0.551	1.496	24mm
01-16S	M24 x 1.5	M24 x 1.5	0.472	0.551	0.551	1.496	27mm
01-20S	M30 x 2	M30 x 2	0.63	0.63	0.63	1.732	32mm
01-25S	M36 x 2	M36 x 2	0.787	0.709	0.709	1.968	41mm
01-30S	M42 x 2	M42 x 2	0.984	0.787	0.787	2.125	46mm
01-38S	M52 x 2	M52 x 2	1.26	0.866	0.866	2.402	55mm

Add **-CWNR** to part number for complete with nuts and rings, i.e. **01-06S-CWNR**.

**METRIC male x METRIC male (S Series) -
Body Only**

Nov-21
1404 METRIC

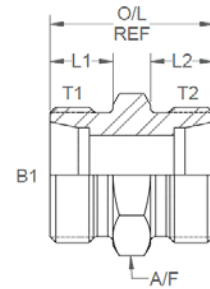

	T1	T2	B1	L1	L2	O/L	A/F
01-06S	M14 x 1.5	M14 x 1.5	4	12	12	30	14mm
01-08S	M16 x 1.5	M16 x 1.5	5	12	12	32	17mm
01-10S	M18 x 1.5	M18 x 1.5	7	12	12	32	19mm
01-12S	M20 x 1.5	M20 x 1.5	8	12	12	34	22mm
01-14S	M22 x 1.5	M22 x 1.5	10	14	14	38	24mm
01-16S	M24 x 1.5	M24 x 1.5	12	14	14	38	27mm
01-20S	M30 x 2	M30 x 2	16	16	16	44	32mm
01-25S	M36 x 2	M36 x 2	20	18	18	50	41mm
01-30S	M42 x 2	M42 x 2	25	20	20	54	46mm
01-38S	M52 x 2	M52 x 2	32	22	22	61	55mm

Add -CWNR to part number for complete with nuts and rings, i.e. 01-06S-CWNR.