

A/F dimensions are imperial unless stated.

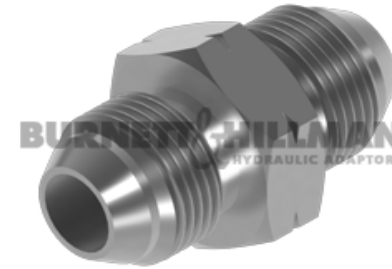
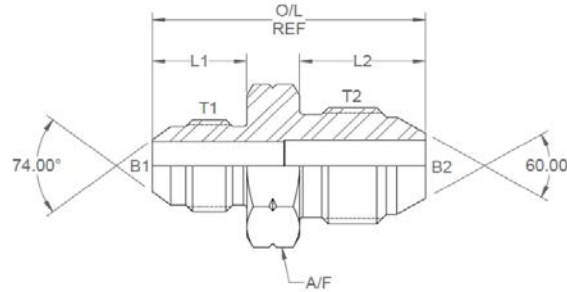

	T1	T2	B1	B2	L1	L2	O/L	A/F
8751-04-14	7/16	M14 x 1.5	0.172 "	0.205 "	0.550 "	0.690 "	1.550 "	17mm
8751-06-18	9/16	M18 x 1.5	0.297 "	0.315 "	0.556 "	0.740 "	1.620 "	22mm
8751-08-22	3/4	M22 x 1.5	0.391 "	0.437 "	0.657 "	0.795 "	1.852 "	27mm
8751-10-24	7/8	M24 x 1.5	0.484 "	0.484 "	0.758 "	0.865 "	2.010 "	27mm
8751-12-30	1-1/16	M30 x 1.5	0.609 "	0.609 "	0.864 "	0.950 "	2.290 "	1.5
8751-16-33	1-5/16	M33 x 1.5	0.844 "	0.864 "	0.911 "	0.960 "	2.370 "	1.5

	T1	T2	B1	B2	L1	L2	O/L	A/F
8751-04-14	7/16	M14 x 1.5	4.37 mm	5.21 mm	13.97 mm	17.53 mm	39.37 mm	17mm
8751-06-18	9/16	M18 x 1.5	7.54 mm	8.00 mm	14.12 mm	18.80 mm	41.15 mm	22mm
8751-08-22	3/4	M22 x 1.5	9.93 mm	11.10 mm	16.69 mm	20.19 mm	47.04 mm	27mm
8751-10-24	7/8	M24 x 1.5	12.29 mm	12.29 mm	19.25 mm	21.97 mm	51.05 mm	27mm
8751-12-30	1-1/16	M30 x 1.5	15.47 mm	15.47 mm	21.95 mm	24.13 mm	58.17 mm	1.5
8751-16-33	1-5/16	M33 x 1.5	21.44 mm	21.95 mm	23.14 mm	24.38 mm	60.20 mm	1.5