

All dimensions are imperial unless stated.

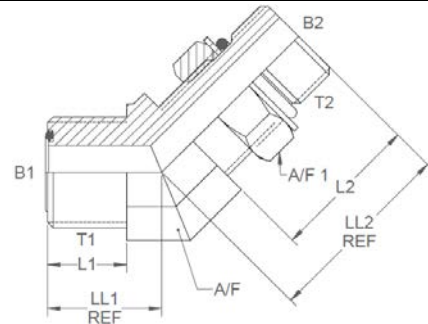

	T1	T2	B1	B2	L1	L2	LL1	LL2	A/F1	A/F
10365-04-04	9/16	7/16	0.172	0.172	0.35	0.81	0.63	1.18	0.625	0.562
10365-04-06	9/16	9/16	0.172	0.295	0.35	0.88	0.63	1.3	0.75	0.750
10365-06-08	11/16	3/4	0.264	0.39	0.41	1.03	0.74	1.43	0.938	0.750
10365-08-08	13/16	3/4	0.378	0.39	0.47	1.03	0.8	1.43	0.938	0.750
10365-10-10	1	7/8	0.484	0.484	0.55	1.19	0.92	1.76	1.062	1.062
10365-12-12	1-3/16	1-1/16	0.609	0.609	0.59	1.33	1.02	1.97	1.375	1.188
10365-12-16	1-3/16	1-5/16	0.609	0.843	0.59	1.36	1.18	2.06	1.625	1.438
10365-16-16	1-7/16	1-5/16	0.811	0.843	0.61	1.36	1.18	2.06	1.625	1.438
10365-20-20	1-11/16	1-5/8	1.024	1.079	0.61	1.36	1.26	2.11	1.875	1.625

A/F dimensions are imperial unless stated.

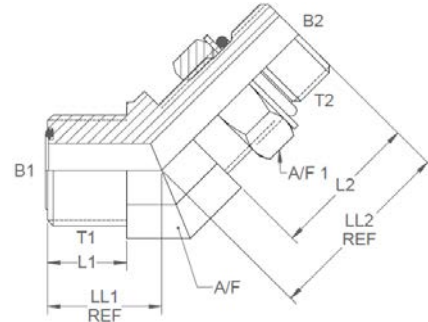

	T1	T2	B1	B2	L1	L2	LL1	LL2	A/F1	A/F
10365-04-04	9/16	7/16	4.37	4.37	8.89	20.57	16	29.97	0.625	0.562
10365-04-06	9/16	9/16	4.37	7.49	8.89	22.35	16	33.02	0.75	0.750
10365-06-08	11/16	3/4	6.71	9.91	10.41	26.16	18.8	36.32	0.938	0.750
10365-08-08	13/16	3/4	9.6	9.91	11.94	26.16	20.32	36.32	0.938	0.750
10365-10-10	1	7/8	12.29	12.29	13.97	30.23	23.37	44.7	1.062	1.062
10365-12-12	1-3/16	1-1/16	15.47	15.47	14.99	33.78	25.91	50.04	1.375	1.188
10365-12-16	1-3/16	1-5/16	15.47	21.41	14.99	34.54	29.97	52.32	1.625	1.438
10365-16-16	1-7/16	1-5/16	20.6	21.41	15.49	34.54	29.97	52.32	1.625	1.438
10365-20-20	1-11/16	1-5/8	26.01	27.41	15.49	34.54	32	53.59	1.875	1.625