

All dimensions are imperial unless stated.

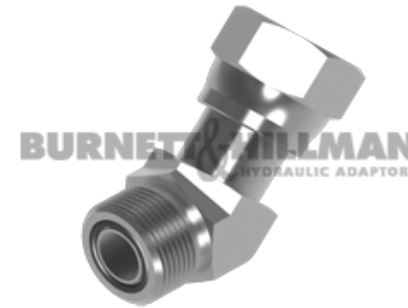

	T1	T2	B1	B2	L1	L2	LL1	LL2	A/F	A/F1
9356-04-04	9/16	9/16	0.172	0.165	0.35	1.04	0.63	1.38	0.562	0.687
9356-06-06	11/16	11/16	0.264	0.264	0.41	1.15	0.74	1.56	0.75	0.812
9356-08-08	13/16	13/16	0.378	0.358	0.47	1.49	0.8	1.84	0.75	0.938
9356-10-10	1	1	0.484	0.453	0.55	1.62	0.92	2.18	1.062	1.125
9356-12-12	1-3/16	1-3/16	0.609	0.547	0.59	1.82	1.02	2.46	1.188	1.375
9356-16-16	1-7/16	1-7/16	0.811	0.783	0.61	2.01	1.18	2.54	1.438	1.625
9356-20-20	1-11/16	1-11/16	1.024	1.024	0.61	2.29	1.26	2.7	1.625	1.875
9356-24-24	2	2	1.26	1.26	0.61	2.41	1.45	2.76	1.875	2.25

A/F dimensions are imperial unless stated.

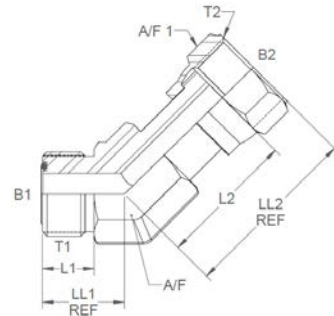
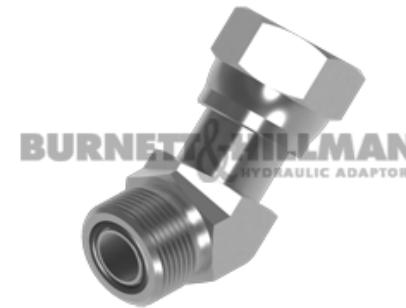
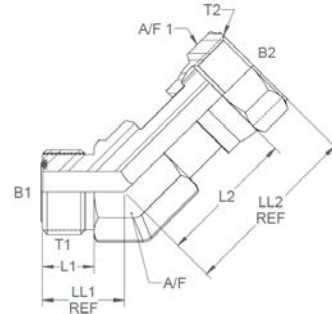

	T1	T2	B1	B2	L1	L2	LL1	LL2	A/F	A/F1
9356-04-04	9/16	9/16	4.37	4.19	8.89	26.42	16	35.05	0.562	0.687
9356-06-06	11/16	11/16	6.71	6.71	10.41	29.21	18.8	39.62	0.75	0.812
9356-08-08	13/16	13/16	9.6	9.09	11.94	37.85	20.32	46.74	0.75	0.938
9356-10-10	1	1	12.29	11.51	13.97	41.15	23.37	55.37	1.062	1.125
9356-12-12	1-3/16	1-3/16	15.47	13.89	14.99	46.23	25.91	62.48	1.188	1.375
9356-16-16	1-7/16	1-7/16	20.6	19.89	15.49	51.05	29.97	64.52	1.438	1.625
9356-20-20	1-11/16	1-11/16	26.01	26.01	15.49	58.17	32	68.58	1.625	1.875
9356-24-24	2	2	32	32	15.49	61.21	36.83	70.1	1.875	2.25