

All dimensions are imperial unless stated.

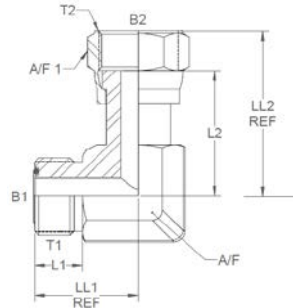

	T1	T2	B1	B2	L1	L2	LL1	LL2	A/F	A/F1
9506-04-04	9/16	9/16	0.172	0.165	0.35	1.04	0.85	1.38	0.562	0.687
9506-06-06	11/16	11/16	0.264	0.264	0.41	1.15	0.98	1.56	0.75	0.812
9506-08-08	13/16	13/16	0.378	0.358	0.47	1.49	1.1	1.84	0.75	0.938
9506-10-10	1	1	0.484	0.453	0.55	1.62	1.31	2.18	1.062	1.125
9506-12-12	1-3/16	1-3/16	0.609	0.547	0.59	1.82	1.47	2.46	1.188	1.375
9506-16-16	1-7/16	1-7/16	0.811	0.783	0.61	2.01	1.64	2.72	1.438	1.625
9506-20-20	1-11/16	1-11/16	1.024	1.024	0.61	2.29	1.76	2.81	1.625	1.875
9506-24-24	2	2	1.26	1.26	0.61	2.41	1.92	2.91	1.875	2.25

**ORFS male x ORFS swivel female 90°
forged compact elbow**

Nov-21
0919 METRIC

A/F dimensions are imperial unless stated.

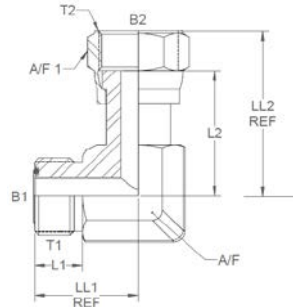

	T1	T2	B1	B2	L1	L2	LL1	LL2	A/F	A/F1
9506-04-04	9/16	9/16	4.37	4.19	8.89	26.42	21.59	35.05	0.562	0.687
9506-06-06	11/16	11/16	6.71	6.71	10.41	29.21	24.89	39.62	0.75	0.812
9506-08-08	13/16	13/16	9.6	9.09	11.94	37.85	27.94	46.74	0.75	0.938
9506-10-10	1	1	12.29	11.51	13.97	41.15	33.27	55.37	1.062	1.125
9506-12-12	1-3/16	1-3/16	15.47	13.89	14.99	46.23	37.34	62.48	1.188	1.375
9506-16-16	1-7/16	1-7/16	20.6	19.89	15.49	51.05	41.66	69.09	1.438	1.625
9506-20-20	1-11/16	1-11/16	26.01	26.01	15.49	58.17	44.7	71.37	1.625	1.875
9506-24-24	2	2	32	32	15.49	61.21	48.77	73.91	1.875	2.25