

All dimensions are imperial unless stated.

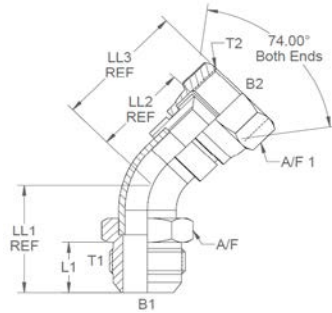

	T1	T2	B1	B2	L1	LL1	LL2	LL3	A/F	A/F1
11904	7/8	7/8	0.484	0.5	0.758	1.652	1.292	1.796	1	1
11900	7/16	7/16	0.172	0.176	0.55	1.266	0.853	1.207	0.5	0.562
11902	9/16	9/16	0.297	0.296	0.556	1.349	0.974	1.365	0.625	0.687
11903	3/4	3/4	0.391	0.39	0.657	1.519	1.245	1.685	0.812	0.875
11905	1-1/16	1-1/16	0.609	0.593	0.864	1.952	1.433	2.007	1.125	1.25
11907	1-5/16	1-5/16	0.844	0.811	0.911	1.957	1.688	2.299	1.375	1.5
11908	1-5/8	1-5/8	1.02	1.075	0.957	2.395	1.939	2.6	1.75	50mm

A/F dimensions are imperial unless stated.

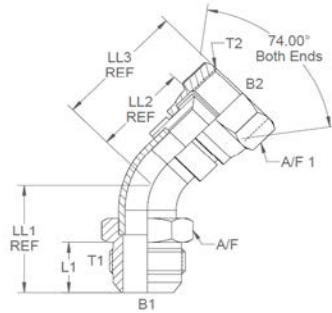

	T1	T2	B1	B2	L1	LL1	LL2	LL3	A/F	A/F1
11904	7/8	7/8	12.29	12.7	19.25	41.96	32.82	45.62	1	1
11900	7/16	7/16	4.37	4.47	13.97	32.16	21.67	30.66	0.5	0.562
11902	9/16	9/16	7.54	7.52	14.12	34.26	24.74	34.67	0.625	0.687
11903	3/4	3/4	9.93	9.91	16.69	38.58	31.62	42.8	0.812	0.875
11905	1-1/16	1-1/16	15.47	15.06	21.95	49.58	36.4	50.98	1.125	1.25
11907	1-5/16	1-5/16	21.44	20.6	23.14	49.71	42.88	58.39	1.375	1.5
11908	1-5/8	1-5/8	25.91	27.31	24.31	60.83	49.25	66.04	1.75	50mm