

All dimensions are imperial unless stated.

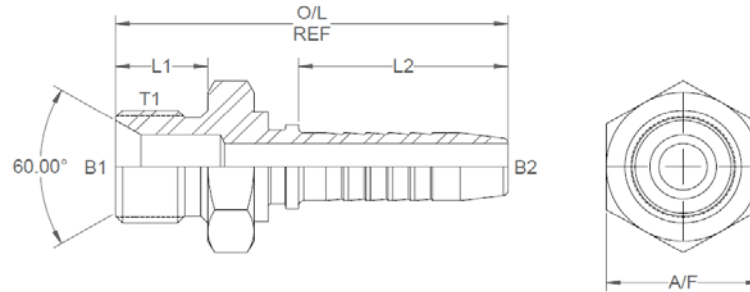

	T1	T2	B1	B2	L1	L2	O/L	A/F
19920	1/4	1/4 HT	0.197	0.156	0.433	1.105	2.093	19mm
19921	3/8	3/8 HT	0.375	0.271	0.472	1.18	2.304	22mm
19922	1/2	1/2 HT	0.472	0.375	0.552	1.29	2.58	27mm
19923	5/8	5/8 HT	0.551	0.472	0.63	1.412	2.776	30mm
19924	3/4	3/4 HT	0.609	0.609	0.75	1.555	3.055	32mm
19925	1	1 HT	0.843	0.797	0.8	1.85	3.43	41mm
19927	1-1/4	1-1/4 HT	1.203	1.03	0.8	2.158	3.793	50mm

A/F dimensions are imperial unless stated.

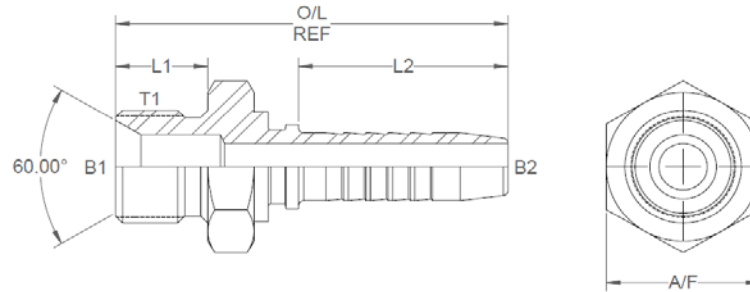

	T1	T2	B1	B2	L1	L2	O/L	A/F
19920	1/4	1/4 HT	5	3.96	11	28.07	53.16	19mm
19921	3/8	3/8 HT	9.53	6.88	11.99	29.97	58.52	22mm
19922	1/2	1/2 HT	11.99	9.53	14.02	32.77	65.53	27mm
19923	5/8	5/8 HT	14	11.99	16	35.86	70.51	30mm
19924	3/4	3/4 HT	15.47	15.47	19.05	39.5	77.6	32mm
19925	1	1 HT	21.41	20.24	20.32	46.99	87.12	41mm
19927	1-1/4	1-1/4 HT	30.56	26.16	20.32	54.81	96.34	50mm