

NPTF fixed female x NPTF fixed female 90° compact elbow

Oct-21
0623 IMP

All dimensions are imperial unless stated.

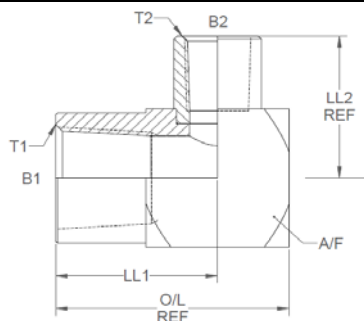

	T1	T2	B1	B2	O/L	LL1	LL2	A/F
06082	1/8	1/8	8.38	8.38	26.16	18.03	18.72	0.625
06075	1/4	1/4	10.69	10.69	34.42	24.59	24.64	0.75
06084	3/8	1/4	14.25	10.69	41.28	28.58	27.81	1
06074	1/2	1/4	17.5	10.69	46.61	32.31	29.39	1.125
06076	3/8	3/8	14.25	14.25	41.28	28.58	28.58	1
06085	1/2	3/8	17.5	14.25	46.61	32.31	30.15	1.125
06073	3/4	3/8	22.73	14.25	53.34	35.56	33.32	1.375
06077	1/2	1/2	17.5	17.5	46.61	32.31	33.07	1.125
06078	3/4	3/4	22.73	22.73	53.34	35.56	38.91	1.375
06079	1	1	28.5	28.5	66.68	44.45	44.07	1.75
06080	1-1/4	1-1/4	37.49	37.49	78.41	51.74	50.8	2
06081	1-1/2	1-1/2	43.51	43.51	90.17	57.79	57.15	2.5
06083	2	2	54.99	54.99	107.06	68.96	67.31	3

DESIGN DETAILS AND SPECIFICATIONS SUBJECT TO CHANGE WITHOUT PRIOR NOTICE - Whilst every effort has been made to ensure the accuracy of the information supplied herein, Burnett & Hillman cannot be held responsible for any errors or omissions (E&OE)

NPTF fixed female x NPTF fixed female
90° compact elbow

Oct-21
 0623 METRIC

A/F dimensions are imperial unless stated.

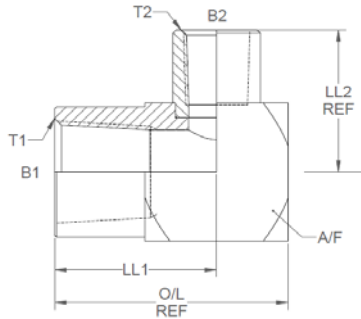

	T1	T2	B1	B2	O/L	LL1	LL2	A/F
06082	1/8	1/8	0.33	0.33	1.03	0.71	0.737	0.625
06075	1/4	1/4	0.421	0.421	1.355	0.968	0.97	0.75
06084	3/8	1/4	0.561	0.421	1.625	1.125	1.095	1
06074	1/2	1/4	0.689	0.421	1.835	1.272	1.157	1.125
06076	3/8	3/8	0.561	0.561	1.625	1.125	1.125	1
06085	1/2	3/8	0.689	0.561	1.835	1.272	1.187	1.125
06073	3/4	3/8	0.895	0.561	2.1	1.4	1.312	1.375
06077	1/2	1/2	0.689	0.689	1.835	1.272	1.302	1.125
06078	3/4	3/4	0.895	0.895	2.1	1.4	1.532	1.375
06079	1	1	1.122	1.122	2.625	1.75	1.735	1.75
06080	1-1/4	1-1/4	1.476	1.476	3.087	2.037	2	2
06081	1-1/2	1-1/2	1.713	1.713	3.55	2.275	2.25	2.5
06083	2	2	2.165	2.165	4.215	2.715	2.65	3