

All dimensions are imperial unless stated.

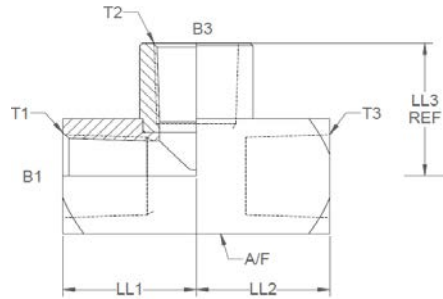

	T1	T2	T3	B1	B3	LL1	LL2	LL3	A/F
07000	1/8	1/8	1/8	0.33	0.33	0.775	0.775	0.737	0.625
07001	1/4	1/4	1/4	0.421	0.421	0.89	0.89	0.89	19mm
07002	3/8	3/8	3/8	0.561	0.561	1	1	1.125	1
07003	1/2	1/2	1/2	0.689	0.689	1.25	1.25	1.302	1.125
07004	3/4	3/4	3/4	0.895	0.895	1.5	1.5	1.532	1.375
07005	1	1	1	1.137	1.137	1.725	1.725	1.735	1.75
07006	1-1/4	1-1/4	1-1/4	1.476	1.476	2.062	2.062	2	2
07007	1-1/2	1-1/2	1-1/2	1.713	1.713	2.25	2.25	2.25	2.5
07008	2	2	2	2.165	2.165	2.65	2.65	2.65	3