

**BSP male x BSP male x BSP swivel  
female branch tee ENLARGING ON  
BRANCH**

Oct-21  
0511 IMP

All dimensions are imperial unless stated.

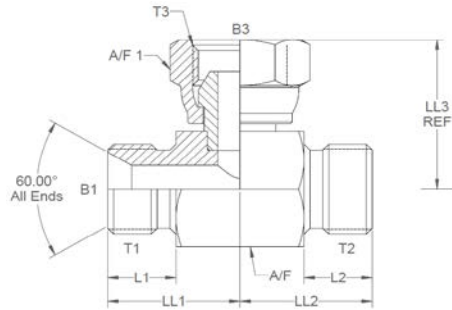

	T1	T2	T3	B1	B3	L1	L2	LL1	LL2	LL3	A/F	A/F1
02009	1/4	1/4	3/8	0.185	0.271	0.45	0.45	0.832	0.832	1.09	0.625	22mm
02011	3/8	3/8	1/2	0.312	0.375	0.52	0.52	1.085	1.085	1.36	27mm	27mm

**BSP male x BSP male x BSP swivel  
female branch tee ENLARGING ON  
BRANCH**

Oct-21  
0511 METRIC

A/F dimensions are imperial unless stated.

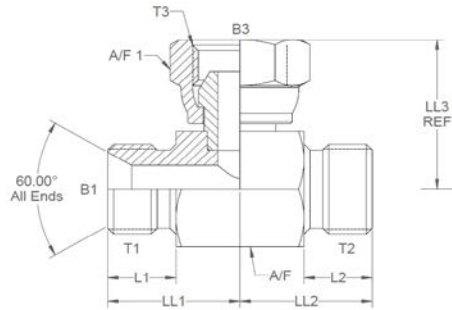

	T1	T2	T3	B1	B3	L1	L2	LL1	LL2	LL3	A/F	A/F1
02009	1/4	1/4	3/8	0.185	0.271	0.45	0.45	0.832	0.832	1.09	0.625	22mm
02011	3/8	3/8	1/2	0.312	0.375	0.52	0.52	1.085	1.085	1.36	27mm	27mm