

All dimensions are imperial unless stated.

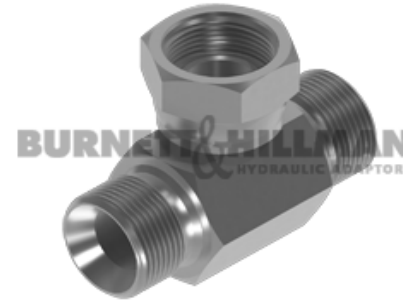
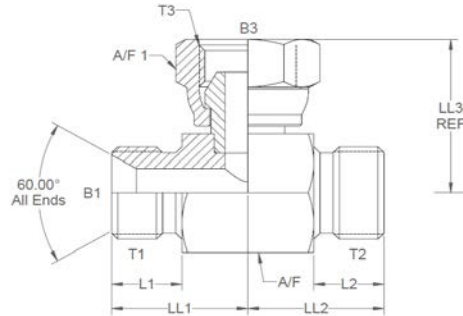

	T1	T2	T3	B1	B3	L1	L2	LL1	LL2	LL3	A/F	A/F1
02000	1/8	1/8	1/8	0.137	0.125	0.44	0.44	0.77	0.77	0.83	14mm	14mm
02001	1/4	1/4	1/4	0.185	0.172	0.45	0.45	0.88	0.88	1.04	19mm	19mm
02002	3/8	3/8	3/8	0.312	0.271	0.52	0.52	1	1	1.22	22mm	22mm
02003	1/2	1/2	1/2	0.437	0.375	0.6	0.6	1.163	1.163	1.376	27mm	27mm
02004	5/8	5/8	5/8	0.562	0.437	0.7	0.7	1.32	1.32	1.53	30mm	30mm
02005	3/4	3/4	3/4	0.625	0.562	0.75	0.75	1.48	1.48	1.569	32mm	32mm
02006	1	1	1	0.875	0.75	0.8	0.8	1.7	1.7	1.849	41mm	41mm
02007	1-1/4	1-1/4	1-1/4	1.125	0.875	0.8	0.8	1.925	1.925	2.183	50mm	50mm
02012	1-1/2	1-1/2	1-1/2	1.312	0.96	0.85	0.85	2.225	2.225	2.36	55mm	55mm
01997	2	2	2	1.75	1.3	1	1	2.6	2.6	2.87	70mm	70mm

DESIGN DETAILS AND SPECIFICATIONS SUBJECT TO CHANGE WITHOUT PRIOR NOTICE - Whilst every effort has been made to ensure the accuracy of the information supplied herein, Burnett & Hillman cannot be held responsible for any errors or omissions (E&OE)

A/F dimensions are imperial unless stated.

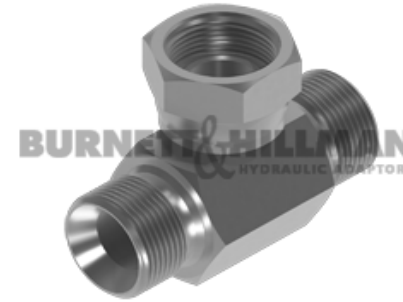
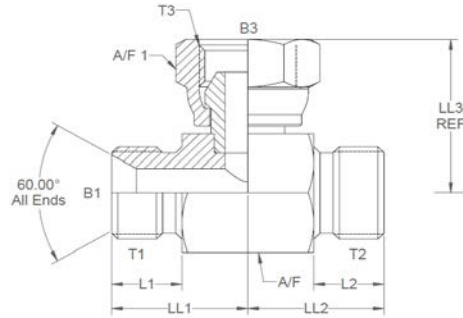

	T1	T2	T3	B1	B3	L1	L2	LL1	LL2	LL3	A/F	A/F1
02000	1/8	1/8	1/8	3.48	3.18	11.18	11.18	19.56	19.56	21.08	14mm	14mm
02001	1/4	1/4	1/4	4.7	4.37	11.43	11.43	22.35	22.35	26.42	19mm	19mm
02002	3/8	3/8	3/8	7.92	6.88	13.21	13.21	25.4	25.4	30.99	22mm	22mm
02003	1/2	1/2	1/2	11.1	9.53	15.24	15.24	29.54	29.54	34.95	27mm	27mm
02004	5/8	5/8	5/8	14.27	11.1	17.78	17.78	33.53	33.53	38.86	30mm	30mm
02005	3/4	3/4	3/4	15.88	14.27	19.05	19.05	37.59	37.59	39.85	32mm	32mm
02006	1	1	1	22.23	19.05	20.32	20.32	43.18	43.18	46.96	41mm	41mm
02007	1-1/4	1-1/4	1-1/4	28.58	22.23	20.32	20.32	48.9	48.9	55.45	50mm	50mm
02012	1-1/2	1-1/2	1-1/2	33.32	24.38	21.59	21.59	56.52	56.52	59.94	55mm	55mm
01997	2	2	2	44.45	33.02	25.4	25.4	66.04	66.04	72.9	70mm	70mm