

All dimensions are imperial unless stated.

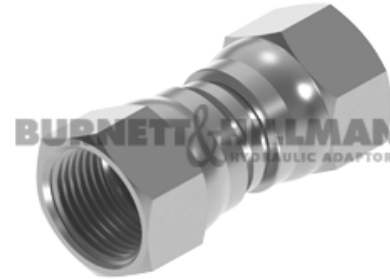
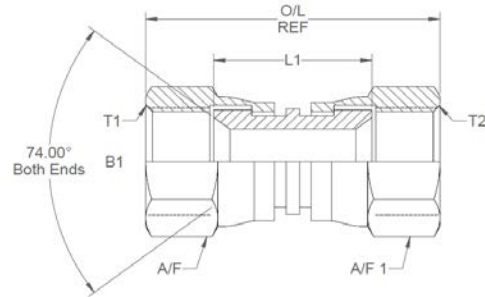

	T1	T2	B1	B2	L1	O/L	A/F	A/F1
01825	7/16	7/16	0.176	0.176	0.726	1.45	0.562	0.562
01832	7/16	9/16	0.176	0.296	0.773	1.54	0.562	0.687
01842	7/16	3/4	0.176	0.39	0.901	1.7	0.562	0.875
01826	1/2	1/2	0.203	0.203	0.758	1.53	0.625	0.625
01833	1/2	9/16	0.203	0.296	0.789	1.58	0.625	0.687
01827	9/16	9/16	0.296	0.296	0.82	1.6	0.687	0.687
01828	9/16	3/4	0.296	0.39	0.948	1.8	0.687	0.875
01834	9/16	7/8	0.296	0.5	0.995	1.89	0.687	1
01829	3/4	3/4	0.39	0.39	1.076	1.97	0.875	0.875
01830	3/4	7/8	0.39	0.5	1.123	2.06	0.875	1
01844	3/4	1-1/16	0.39	0.593	1.165	2.2	0.875	1.25
01831	7/8	7/8	0.5	0.5	1.17	2.18	1	1
01838	7/8	1-1/16	0.5	0.593	1.212	2.29	1	1.25
01835	1-1/16	1-1/16	0.593	0.593	1.254	2.4	1.25	1.25
01837	1-1/16	1-5/16	0.593	0.812	1.287	2.48	1.25	1.5
01841	1-3/16	1-3/16	0.75	0.75	1.204	2.42	1.375	1.375
01836	1-5/16	1-5/16	0.812	0.812	1.32	2.53	1.5	1.5
01839	1-5/8	1-5/8	1.075	1.075	1.382	2.7	50mm	50mm
01845	1-5/8	1-7/8	1.075	1.25	1.491	2.81	50mm	55mm
01840	1-7/8	1-7/8	1.25	1.25	1.6	2.98	55mm	55mm
01843	2-1/2	2-1/2	1.75	1.75	1.785	3.62	70mm	70mm

DESIGN DETAILS AND SPECIFICATIONS SUBJECT TO CHANGE WITHOUT PRIOR NOTICE - Whilst every effort has been made to ensure the accuracy of the information supplied herein, Burnett & Hillman cannot be held responsible for any errors or omissions (E&OE)

A/F dimensions are imperial unless stated.

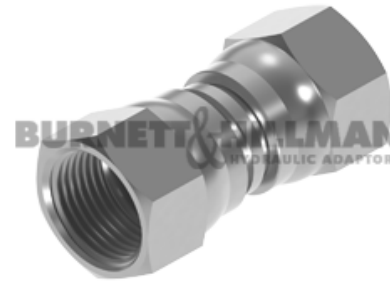
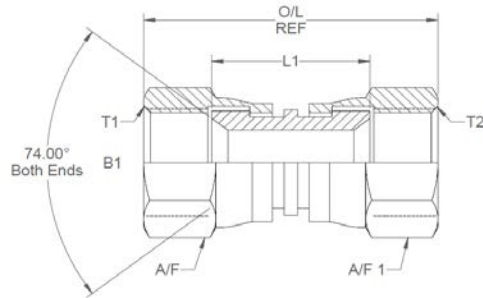

	T1	T2	B1	B2	L1	O/L	A/F	A/F1
01825	7/16	7/16	4.47	4.47	18.44	36.83	0.562	0.562
01832	7/16	9/16	4.47	7.52	19.63	39.12	0.562	0.687
01842	7/16	3/4	4.47	9.91	22.89	43.18	0.562	0.875
01826	1/2	1/2	5.16	5.16	19.25	38.86	0.625	0.625
01833	1/2	9/16	5.16	7.52	20.04	40.13	0.625	0.687
01827	9/16	9/16	7.52	7.52	20.83	40.64	0.687	0.687
01828	9/16	3/4	7.52	9.91	24.08	45.72	0.687	0.875
01834	9/16	7/8	7.52	12.7	25.27	48.01	0.687	1
01829	3/4	3/4	9.91	9.91	27.33	50.04	0.875	0.875
01830	3/4	7/8	9.91	12.7	28.52	52.32	0.875	1
01844	3/4	1-1/16	9.91	15.06	29.59	55.88	0.875	1.25
01831	7/8	7/8	12.7	12.7	29.72	55.37	1	1
01838	7/8	1-1/16	12.7	15.06	30.78	58.17	1	1.25
01835	1-1/16	1-1/16	15.06	15.06	31.85	60.96	1.25	1.25
01837	1-1/16	1-5/16	15.06	20.62	32.69	62.99	1.25	1.5
01841	1-3/16	1-3/16	19.05	19.05	30.58	61.47	1.375	1.375
01836	1-5/16	1-5/16	20.62	20.62	33.53	64.26	1.5	1.5
01839	1-5/8	1-5/8	27.31	27.31	35.1	68.58	50mm	50mm
01845	1-5/8	1-7/8	27.31	31.75	37.87	71.37	50mm	55mm
01840	1-7/8	1-7/8	31.75	31.75	40.64	75.69	55mm	55mm
01843	2-1/2	2-1/2	44.45	44.45	45.34	91.95	70mm	70mm

DESIGN DETAILS AND SPECIFICATIONS SUBJECT TO CHANGE WITHOUT PRIOR NOTICE - Whilst every effort has been made to ensure the accuracy of the information supplied herein, Burnett & Hillman cannot be held responsible for any errors or omissions (E&OE)