

All dimensions are imperial unless stated.

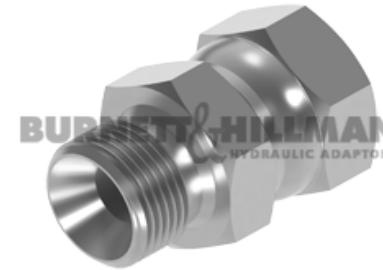
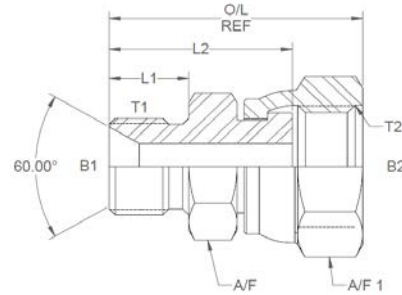

	T1	T2	B1	B2	L1	L2	O/L	A/F	A/F1
11426	1/8	1/4	0.172	0.172	0.44	1.02	1.365	19mm	19mm
11427	1/4	1/4	0.25	0.172	0.45	1.02	1.374	19mm	19mm
11429	1/4	3/8	0.185	0.185	0.45	1.08	1.5	19mm	22mm
11433	3/8	1/4	0.312	0.172	0.52	1.126	1.45	22mm	19mm
11434	3/8	3/8	0.312	0.271	0.52	1.188	1.6	22mm	22mm
11435	3/8	1/2	0.312	0.312	0.52	1.19	1.66	22mm	27mm
11436	3/8	3/4	0.375	0.375	0.52	1.24	1.8	30mm	32mm
11440	1/2	1/2	0.437	0.375	0.6	1.34	1.8	27mm	27mm
11442	1/2	3/4	0.437	0.6	0.6	1.349	1.92	30mm	32mm
11446	5/8	5/8	0.5	0.5	0.7	1.42	1.98	30mm	30mm
11451	3/4	3/4	0.659	0.6	0.75	1.488	2.06	32mm	32mm
11458	1	1	0.875	0.797	0.8	1.58	2.23	41mm	41mm
11463	0	0	0	0	0	0	0	0	0
11467	2	2	1.75	1.75	1	2.165	3.05	70mm	70mm

DESIGN DETAILS AND SPECIFICATIONS SUBJECT TO CHANGE WITHOUT PRIOR NOTICE - Whilst every effort has been made to ensure the accuracy of the information supplied herein, Burnett & Hillman cannot be held responsible for any errors or omissions (E&OE)

A/F dimensions are imperial unless stated.

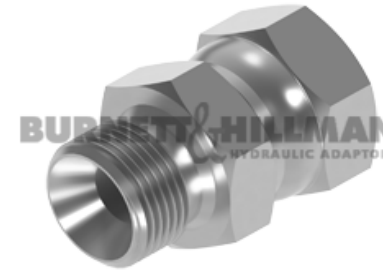
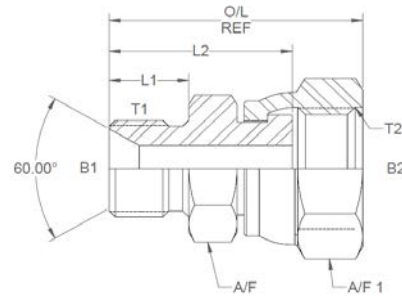

	T1	T2	B1	B2	L1	L2	O/L	A/F	A/F1
11426	1/8	1/4	4.37	4.37	11.18	25.91	34.67	19mm	19mm
11427	1/4	1/4	6.35	4.37	11.43	25.91	34.9	19mm	19mm
11429	1/4	3/8	4.7	4.7	11.43	27.43	38.1	19mm	22mm
11433	3/8	1/4	7.92	4.37	13.21	28.6	36.83	22mm	19mm
11434	3/8	3/8	7.92	6.88	13.21	30.18	40.64	22mm	22mm
11435	3/8	1/2	7.92	7.92	13.21	30.23	42.16	22mm	27mm
11436	3/8	3/4	9.53	9.53	13.21	31.5	45.72	30mm	32mm
11440	1/2	1/2	11.1	9.53	15.24	34.04	45.72	27mm	27mm
11442	1/2	3/4	11.1	15.24	15.24	34.26	48.77	30mm	32mm
11446	5/8	5/8	12.7	12.7	17.78	36.07	50.29	30mm	30mm
11451	3/4	3/4	16.74	15.24	19.05	37.8	52.32	32mm	32mm
11458	1	1	22.23	20.24	20.32	40.13	56.64	41mm	41mm
11463	0	0	0	0	0	0	0	0	0
11467	2	2	44.45	44.45	25.4	54.99	77.47	70mm	70mm

DESIGN DETAILS AND SPECIFICATIONS SUBJECT TO CHANGE WITHOUT PRIOR NOTICE - Whilst every effort has been made to ensure the accuracy of the information supplied herein, Burnett & Hillman cannot be held responsible for any errors or omissions (E&OE)