

All dimensions are imperial unless stated.

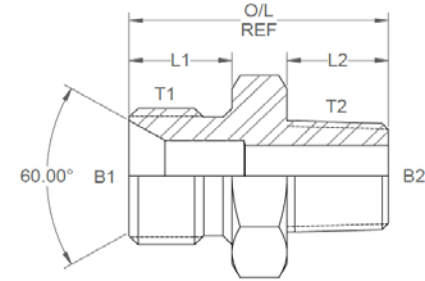
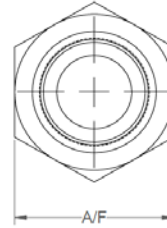
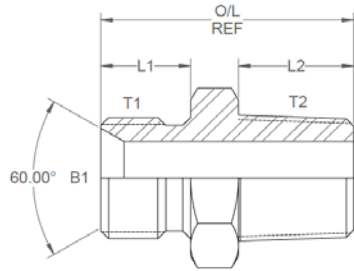

	T1	T2	B1	B2	L1	L2	O/L	A/F
00301	1/8	1/8	0.137		0.44	0.4	1.04	14mm
00302	1/8	1/4	0.137	0.25	0.44	0.58	1.32	14mm
00303	1/8	3/8	0.156	0.375	0.44	0.59	1.35	0.687
00304	1/8	1/2	0.187	0.5	0.44	0.77	1.52	22mm
00305	1/4	1/8	0.185		0.45	0.41	1.1	19mm
00306	1/4	1/4	0.185		0.45	0.58	1.28	19mm
00307	1/4	3/8	0.185	0.375	0.45	0.59	1.32	19mm
00308	1/4	1/2	0.185	0.5	0.45	0.76	1.53	22mm
00310	1/4	3/4	0.25	0.687	0.45	0.77	1.64	27mm
00311	3/8	1/8	0.375	0.187	0.52	0.437	1.177	22mm
00312	3/8	1/4	0.312	0.25	0.52	0.25	1.35	22mm
00313	3/8	3/8	0.312		0.52	0.59	1.43	22mm
00314	3/8	1/2	0.312	0.5	0.52	0.76	1.63	22mm
00315	3/8	5/8	0.312	0.593	0.52	0.77	1.61	24mm
00316	3/8	3/4	0.312	0.687	0.52	0.77	1.71	27mm
00317	3/8	1	0.312	0.875	0.52	0.99	1.89	1.375
00318	1/2	1/8	0.5	0.187	0.6	0.437	1.287	27mm
00319	1/2	1/4	0.437	0.25	0.6	0.58	1.48	27mm
00320	1/2	3/8	0.437	0.375	0.6	0.59	1.51	27mm
00321	1/2	1/2	0.437		0.6	0.77	1.67	27mm

DESIGN DETAILS AND SPECIFICATIONS SUBJECT TO CHANGE WITHOUT PRIOR NOTICE - Whilst every effort has been made to ensure the accuracy of the information supplied herein, Burnett & Hillman cannot be held responsible for any errors or omissions (E&OE)

All dimensions are imperial unless stated.

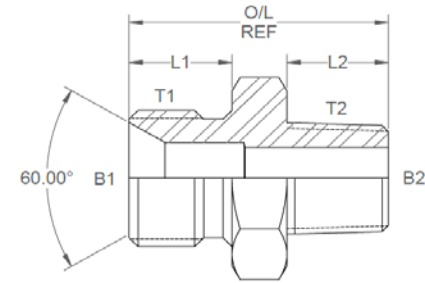
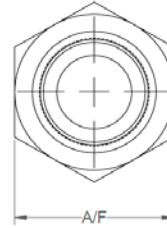
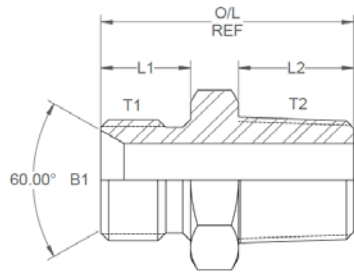

	T1	T2	B1	B2	L1	L2	O/L	A/F
00322	1/2	5/8	0.5		0.6	0.87	1.72	1.01
00323	1/2	3/4	0.437	0.687	0.6	0.77	1.79	27mm
00324	1/2	1	0.437	0.875	0.6	0.99	2.05	1.375
00360	1/2	1-1/4	0.5	1.203	0.6	1	2.1	1.75
00325	5/8	1/4	0.593	0.25	0.7	0.64	1.64	30mm
00326	5/8	3/8	0.562	0.375	0.7	0.59	1.69	30mm
00327	5/8	1/2	0.562	0.5	0.7	0.77	1.79	30mm
00328	5/8	5/8	0.593		0.7	0.77	1.82	30mm
00329	5/8	3/4	0.593	0.687	0.7	0.77	1.87	30mm
00330	3/4	1/4	0.659	0.25	0.75	0.58	1.7	32mm
00331	3/4	3/8	0.659	0.375	0.75	0.59	1.66	32mm
00332	3/4	1/2	0.659	0.5	0.75	0.77	1.84	32mm
00333	3/4	5/8	0.718	0.593	0.75	0.77	1.87	32mm
00334	3/4	3/4	0.659		0.75	0.77	1.94	32mm
00335	3/4	1	0.659	0.875	0.75	0.99	2.24	1.375
00336	3/4	1-1/4	0.659	1.203	0.75	1	2.25	1.75
00365	3/4	1-1/2	0.659	1.312	0.75	1.17	2.42	50mm
00367	3/4	2	0.659	1.812	0.75	1.18	2.48	65mm
00337	1	1/4	0.875	0.25	0.8	0.58	1.73	41mm
00361	1	3/8	0.875	0.375	0.8	0.67	1.82	41mm

DESIGN DETAILS AND SPECIFICATIONS SUBJECT TO CHANGE WITHOUT PRIOR NOTICE - Whilst every effort has been made to ensure the accuracy of the information supplied herein, Burnett &amp; Hillman cannot be held responsible for any errors or omissions (E&amp;OE)

All dimensions are imperial unless stated.

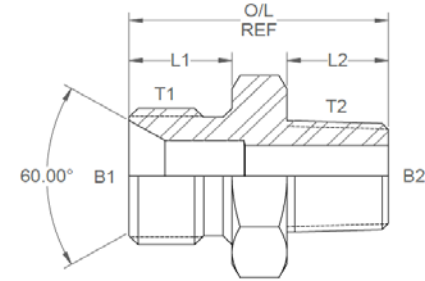
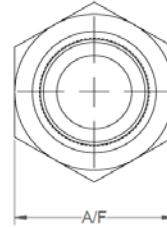
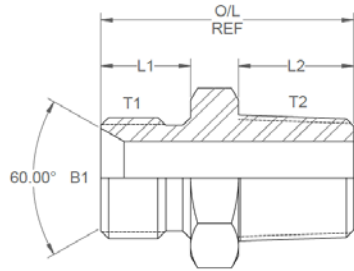

	T1	T2	B1	B2	L1	L2	O/L	A/F
00338	1	1/2	0.875	0.5	0.8	0.76	1.91	41mm
00339	1	3/4	0.875	0.687	0.8	0.77	1.99	41mm
00340	1	1	0.875		0.8	1	2.23	41mm
00341	1	1-1/4	0.875	1.203	0.8	1	2.3	1.75
00342	1	1-1/2	0.875	1.312	0.8	1.17	2.52	50mm
00343	1	2	0.875	1.812	0.8	1.18	2.53	65mm
00344	1-1/4	3/4	1.125	0.687	0.8	0.77	2.02	50mm
00345	1-1/4	1	1.125	0.875	0.8	0.99	2.29	50mm
00346	1-1/4	1-1/4	1.125		0.8	1	2.3	50mm
00347	1-1/4	1-1/2	1.203	1.312	0.8	1.17	2.52	50mm
00348	1-1/4	2	1.125	1.812	0.8	1.18	2.53	50mm
00349	1-1/2	1	1.312	0.875	0.85	0.99	2.39	55mm
00350	1-1/2	1-1/4	1.312	1.203	0.85	1	2.35	55mm
00351	1-1/2	1-1/2	1.312		0.85	1.17	2.52	55mm
00352	1-1/2	2	1.312	1.812	0.85	1.18	2.58	65mm
00353	2	1	1.812	0.875	1	0.99	2.49	70mm
00354	2	1-1/4	1.812	1.203	1	1.1	2.6	70mm
00355	2	1-1/2	1.812	1.312	1	1.17	2.72	70mm
00356	2	2	1.812		1	1.18	2.73	70mm
00363	2	2-1/2	1.812	2.375	1	1.562	3.182	3.25

DESIGN DETAILS AND SPECIFICATIONS SUBJECT TO CHANGE WITHOUT PRIOR NOTICE - Whilst every effort has been made to ensure the accuracy of the information supplied herein, Burnett &amp; Hillman cannot be held responsible for any errors or omissions (E&amp;OE)

All dimensions are imperial unless stated.

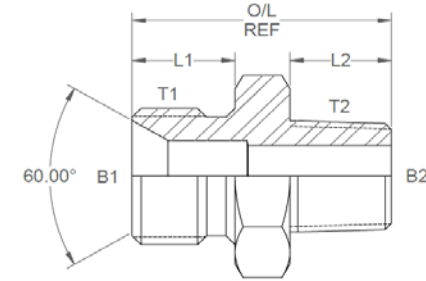
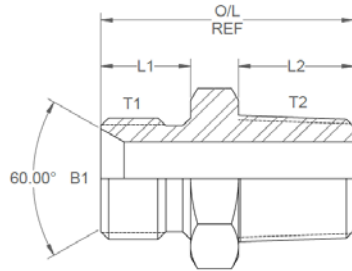

	T1	T2	B1	B2	L1	L2	O/L	A/F
00362	2	3	1.812	2.75	1	1.562	3.187	90mm
00359	2-1/2	2	2.37	1.812	1	1.18	2.78	3.25
00357	2-1/2	2-1/2	2.37	0	1	1.562	3.187	3.25
00364	2-1/2	3	2.37	2.75	1	1.562	3.187	3.25
00369	3	2-1/2	0	0	0	0	0	0
00358	3	3	2.75		1	1.562	3.187	95mm
00366	4	4	3.75		1	1.68	3.3	4.75

A/F dimensions are imperial unless stated.

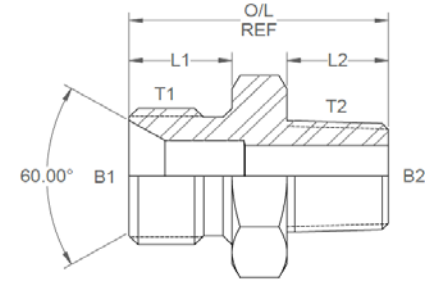
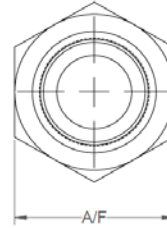
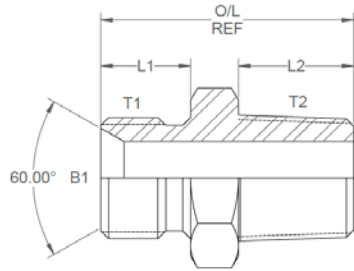

	T1	T2	B1	B2	L1	L2	O/L	A/F
00301	1/8	1/8	3.48		11.18	10.16	1.04	14mm
00302	1/8	1/4	3.48	6.35	11.18	14.73	1.32	14mm
00303	1/8	3/8	3.96	9.53	11.18	14.99	1.35	0.687
00304	1/8	1/2	4.75	12.70	11.18	19.56	1.52	22mm
00305	1/4	1/8	4.7		11.43	10.41	1.1	19mm
00306	1/4	1/4	4.7		11.43	14.73	1.28	19mm
00307	1/4	3/8	4.70	9.53	11.43	14.99	1.32	19mm
00308	1/4	1/2	4.70	12.70	11.43	19.30	1.53	22mm
00310	1/4	3/4	6.35	17.45	11.43	19.56	1.64	27mm
00311	3/8	1/8	9.53	4.75	13.21	11.10	1.177	22mm
00312	3/8	1/4	7.92	6.35	13.21	6.35	1.35	22mm
00313	3/8	3/8	7.92		13.21	14.99	1.43	22mm
00314	3/8	1/2	7.92	12.70	13.21	19.30	1.63	22mm
00315	3/8	5/8	7.92	15.06	13.21	19.56	1.61	24mm
00316	3/8	3/4	7.92	17.45	13.21	19.56	1.71	27mm
00317	3/8	1	7.92	22.23	13.21	25.15	1.89	1.375
00318	1/2	1/8	12.70	4.75	15.24	11.10	1.287	27mm
00319	1/2	1/4	11.10	6.35	15.24	14.73	1.48	27mm
00320	1/2	3/8	11.10	9.53	15.24	14.99	1.51	27mm
00321	1/2	1/2	11.10		15.24	19.56	1.67	27mm

DESIGN DETAILS AND SPECIFICATIONS SUBJECT TO CHANGE WITHOUT PRIOR NOTICE - Whilst every effort has been made to ensure the accuracy of the information supplied herein, Burnett & Hillman cannot be held responsible for any errors or omissions (E&OE)

A/F dimensions are imperial unless stated.

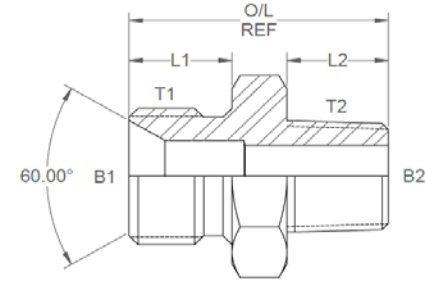
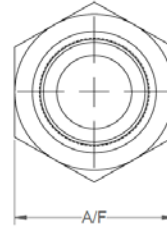
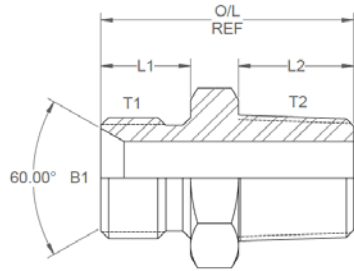

	T1	T2	B1	B2	L1	L2	O/L	A/F
00322	1/2	5/8	12.7		15.24	22.10	43.69	1.01
00323	1/2	3/4	11.1	17.45	15.24	19.56	45.47	27mm
00324	1/2	1	11.1	22.23	15.24	25.15	52.07	1.375
00360	1/2	1-1/4	12.7	30.56	15.24	25.40	53.34	1.75
00325	5/8	1/4	15.06	6.35	17.78	16.26	41.66	30mm
00326	5/8	3/8	14.27	9.53	17.78	14.99	42.93	30mm
00327	5/8	1/2	14.27	12.70	17.78	19.56	45.47	30mm
00328	5/8	5/8	15.06		17.78	19.56	46.23	30mm
00329	5/8	3/4	15.06	17.45	17.78	19.56	47.50	30mm
00330	3/4	1/4	16.74	6.35	19.05	14.73	43.18	32mm
00331	3/4	3/8	16.74	9.53	19.05	14.99	42.16	32mm
00332	3/4	1/2	16.74	12.70	19.05	19.56	46.74	32mm
00333	3/4	5/8	18.24	15.06	19.05	19.56	47.50	32mm
00334	3/4	3/4	16.74		19.05	19.56	49.28	32mm
00335	3/4	1	16.74	22.23	19.05	25.15	56.90	1.375
00336	3/4	1-1/4	16.74	30.56	19.05	25.40	57.15	1.75
00365	3/4	1-1/2	16.74	33.32	19.05	29.72	61.47	50mm
00367	3/4	2	16.74	46.02	19.05	29.97	62.99	65mm
00337	1	1/4	22.23	6.35	20.32	14.73	43.94	41mm
00361	1	3/8	22.23	9.53	20.32	17.02	46.23	41mm

DESIGN DETAILS AND SPECIFICATIONS SUBJECT TO CHANGE WITHOUT PRIOR NOTICE - Whilst every effort has been made to ensure the accuracy of the information supplied herein, Burnett & Hillman cannot be held responsible for any errors or omissions (E&OE)

A/F dimensions are imperial unless stated.

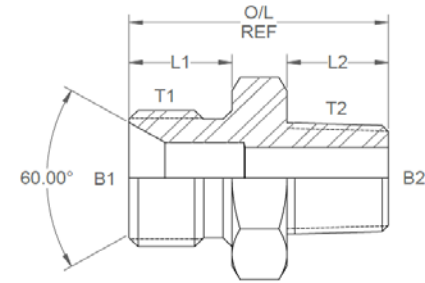
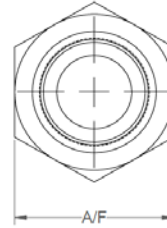
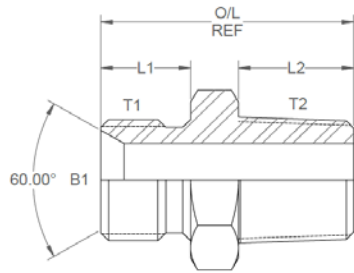

	T1	T2	B1	B2	L1	L2	O/L	A/F
00338	1	1/2	22.23	12.70	20.32	19.30	48.51	41mm
00339	1	3/4	22.23	17.45	20.32	19.56	50.55	41mm
00340	1	1	22.23		20.32	25.40	56.64	41mm
00341	1	1-1/4	22.23	30.56	20.32	25.40	58.42	1.75
00342	1	1-1/2	22.23	33.32	20.32	29.72	64.01	50mm
00343	1	2	22.23	46.02	20.32	29.97	64.26	65mm
00344	1-1/4	3/4	28.58	17.45	20.32	19.56	51.31	50mm
00345	1-1/4	1	28.58	22.23	20.32	25.15	58.17	50mm
00346	1-1/4	1-1/4	28.58		20.32	25.40	58.42	50mm
00347	1-1/4	1-1/2	30.56	33.32	20.32	29.72	64.01	50mm
00348	1-1/4	2	28.58	46.02	20.32	29.97	64.26	50mm
00349	1-1/2	1	33.32	22.23	21.59	25.15	60.71	55mm
00350	1-1/2	1-1/4	33.32	30.56	21.59	25.40	59.69	55mm
00351	1-1/2	1-1/2	33.32		21.59	29.72	64.01	55mm
00352	1-1/2	2	33.32	46.02	21.59	29.97	65.53	65mm
00353	2	1	46.02	22.23	25.40	25.15	63.25	70mm
00354	2	1-1/4	46.02	30.56	25.40	27.94	66.04	70mm
00355	2	1-1/2	46.02	33.32	25.40	29.72	69.09	70mm
00356	2	2	46.02		25.40	29.97	69.34	70mm
00363	2	2-1/2	46.02	60.33	25.40	39.67	80.82	3.25

DESIGN DETAILS AND SPECIFICATIONS SUBJECT TO CHANGE WITHOUT PRIOR NOTICE - Whilst every effort has been made to ensure the accuracy of the information supplied herein, Burnett & Hillman cannot be held responsible for any errors or omissions (E&OE)

A/F dimensions are imperial unless stated.

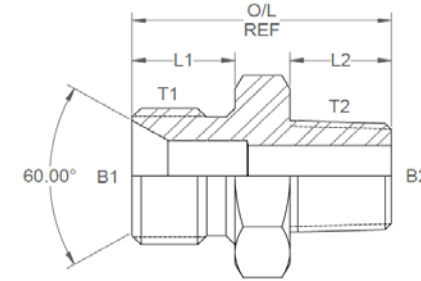
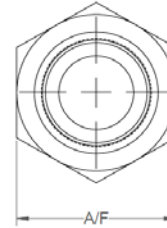
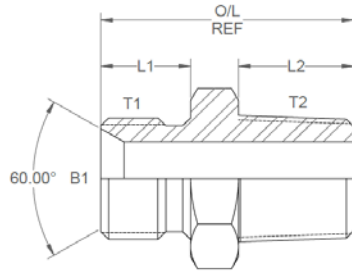

	T1	T2	B1	B2	L1	L2	O/L	A/F
00362	2	3	46.02	69.85	25.40	39.67	80.95	90mm
00359	2-1/2	2	60.2	46.02	25.40	29.97	70.61	3.25
00357	2-1/2	2-1/2	60.2		25.40	39.67	80.95	3.25
00364	2-1/2	3	60.2	69.85	25.40	39.67	80.95	3.25
00369	3	2-1/2	0	0	0	0	0	0
00358	3	3	69.85		25.40	39.67	80.95	95mm
00366	4	4	95.25		25.40	42.67	83.82	4.75